

X-FS Form Stop

Product data

Dimensions

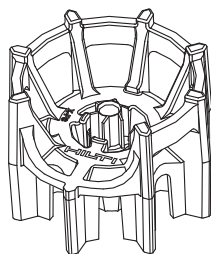
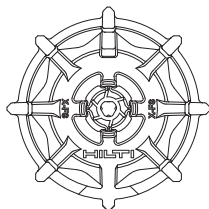
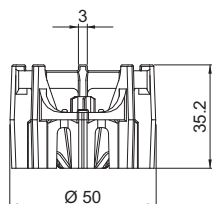

General information

Material specifications

Nail: zinc coating: 5–13 µm

Fastening tool

DX 460, DX 36, DX 460-MX

See fastener selection for more details.

Applications

Examples

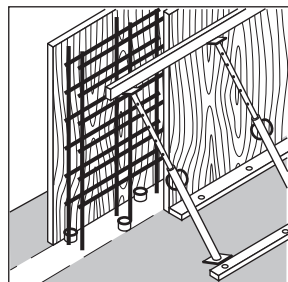

Positioning concrete forms on concrete surfaces. Leave in place, grey polyethylene is non rusting, nearly invisible and non-conductive.

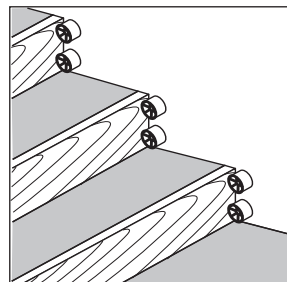
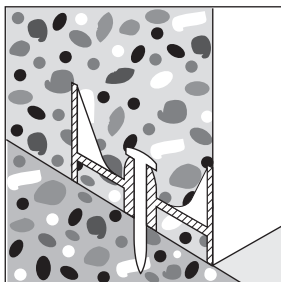

X-FS is suitable and usable for minor forming applications

Load data

Recommended working loads

$V_{rec} = 400 \text{ N}$

(predominantly static, however, vibration from concrete compacting is allowed)

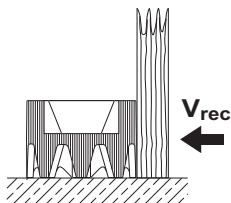

Application requirements

Thickness of base material

Concrete: $h_{min} = 80 \text{ mm}$

Spacing and edge distances

Spacing and edge distances depending on job site requirements.

Corrosion information

For temporary fixations no restrictions exist.

Fastener selection and system recommendation

Fastener

Fastener				Tools
Designation	Item no.	L_s [mm]	Nail shank diameter [mm]	Designation
① X-FS C 52 *	407346	52	3.5	DX 460, DX 36
② X-FS MX **	408022			DX 460-MX

* For unusual applications, X-FS available with other nails on special order

** X-FS without nail for fastening with collated nails.

Cartridge selection and tool energy setting

Cartridge recommendation:	Steel:	6.8/11M red cartridge
	Concrete:	6.8/11M yellow or red cartridge
	Masonry:	6.8/11M yellow or green cartridge

Tool energy adjustment by setting tests on site.

Fastening quality assurance**Installation**

1. Mark out unit to be concreted

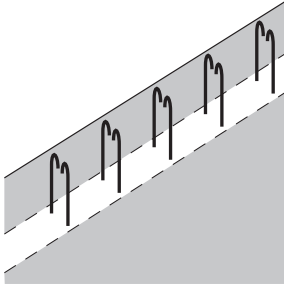

2. Place X-FS tangent to marked out lines.

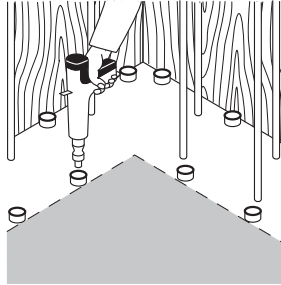

3. Position forms against X-FS.

